









SPARTAN
TRUCK COMPANY, INC.



SRO 60

STANDARD SPARTAN FEATURES

-  60,000 LB CAPACITY
-  HIGH SPEED SINGLE CYLINDER REEVING SYSTEM
-  MODULAR DESIGN & STANDARDIZED PARTS
-  LIGHTWEIGHT DESIGN
-  HIGH STRENGTH DURABLE COMPONENTS
-  EASIER TO SERVICE BY DESIGN
-  QUICK LEADTIMES

 (818) 899-1111

 (818) 897-4366

 info@spartantruck.com

 Spartan Truck Company | 12266 Branford Street |
Sun Valley, CA 91352



For over 40 years, Spartan Truck Company has been the market leader in manufacturing waste equipment on the west coast. We are proud of our quick lead times, high quality components, & extremely durable Roll-Off systems, trailers and waste bodies.



Standard Specifications

Capacity	60,000 lbs
Rail type	Outside, Universal or In/Out
Cable	3/4" x 77'
Cable Strength	66,800 lbs
Hoist Cylinders	6" Bore, 4" Rod x 74" Stroke
Reeving Cylinder	7" Bore, 4" Rod x 90" Stroke
Outside Control Valve	Commercial VA35
Inside Control Valve	Air Operated Dual Levers
Operating Pressure	1800 PSI
Hydraulic Tank	40G with Sight & Temp gauge
Filtration	Suction Strainer & 10 Micron in tank return filter
PTO	Muncie Air Shift or Hot Shift
Pump	Muncie Direct Mount P51
Sheaves	10" with bronze bushings
Container Size	16' - 24'
Dump Angle	44 - 50 Degrees
Body Weight	6,200 lbs Approx
Frame Rails	4" x 10" x 3/8" Rectangular Tubing ASTM A500
Outside Frame	34 1/2" or 35 1/2"
Outside Rollers	(6) 5" OD x 3 1/2" with extractable pins.
ICC Bumper	Fixed or Manually moveable with locking pin
Fenders	Stainless Steel Polished Quarter Fenders
Lighting	Full LED
Electrical	One Piece plug and play harness
Tool Box	Steel Lockable 36" x 18" x 18" with Tarp Basket
Adjustable Stops	(2) Moveable Nose roller stops
Wear Strips	36" Rail mounted wear strips

SRO 60 Technical Specification

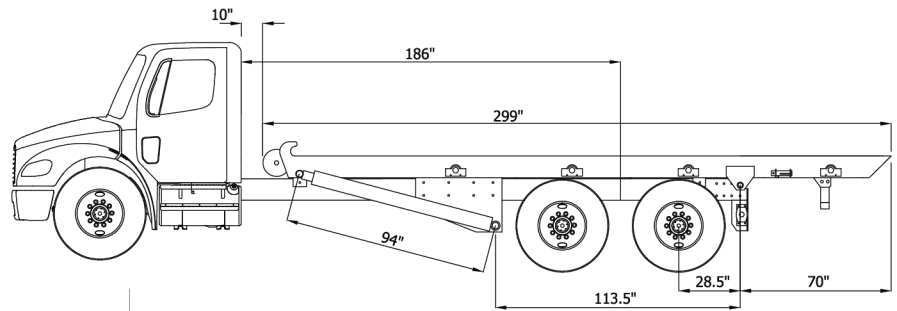

Tie Downs	Dual Ratchet Tiedowns with 3" Straps
Safety Props	Quick Release rail mounted props
Back up Alarm	Audible rear mounted alarm
Warning Lights	Cab mounted PTO and raised rail warning light
Lubrication	Zerk fittings on all wear points

Options

Hitch	Pull or Pup Trailer Hitch Package
Full Fenders	Minimizer Full Tandem Polypropylene
Tarping System	Fully Automatic with adjustable Gantry
Bin Locks	Automatic Container Securement Hooks
Ground Roller	7" Diameter Rear frame roller
Pusher Axle	13,200lb Steerable Hendrickson
On Board Scales	Scale Systems for Air Ride or Mechanical Suspensions