

REPLACEMENT PARTS FOR SWAT® [P/N 1809285]

SWAT System Kit: Base (P/N 1809230) | Wet (P/N 1809285) | R/C (P/N 1809400)

NO.	DESCRIPTION	DONOVAN P/N	COMPETITOR P/N
1	Stabilizer Bar	1808873	HR4753
2	Replacement Roller Bar	1803805	H7002C
3	Tarp Roll Base Rest	1808872	HR4505-2
4	Tarp Tube Bracket	1808866	HR4756
5	Tarp Tube Cap	1809148	HR4757
6	Ratchet Pawl	1809209	HR4788
7	Gantry Cylinder Clevis Eye	1808869	H7032
8	Tarp Tube	1808865	HR4758-2
9	Pawl Torsion Spring	1808851	HR4786
10	Ratchet Pawl Bushing	1808875	HR4787
11	Ratchet Guard Assembly	1809009	HR4789
12	Upper Arm	1808874	HR4751
13	Gantry Telescoping Leg	1808871	HR4512
14	Clevis Pin - 1" OD	1809013	H7062
15	Gantry Base Frame	1808868	HR4511
16	Gantry Cylinder - 36" Stroke	1808891	HR4520
17	1" Shaft Locking Collar	1808855	HR4624
18	Lower Arm	1808879	HR4750

NO.	DESCRIPTION	DONOVAN P/N	COMPETITOR P/N
19	Lower Arm Cylinder - 36" Stroke	1808892	HR4752
20	Pivot Gear Arm	1808887	HR4760
21	Square End Plug	1808846	HR4548A
22	Complete Gear/Pivot Assembly - Left Side	1809355	HR4762A
23	Complete Gear/Pivot Assembly - Right Side	1809360	HR4761A
24	Pivot Pin Assembly	1809168	A3881
25	Rack Cylinder Mounting Pin	1808883	A3883
26	Cylinder Loop Strap	1808881	HR4731
27	Rack Cylinder Connecting Pin	1809014	D18836
28	Castle Nut	1809169	HR4785
29	Pivot Hose Guide	1808859	HR4728
30	Rack/Pivot Cylinder - 16" Stroke	1808890	HR4719
31	Rack Gear	1808886	A3868B
32	Brush Weldments - Left	1809366	N/A
33	Brush Weldments - Right	1809367	N/A

Replacement Tarp - 9'8" x 28' Mighty Mesh®	1801640	HR4616
"Fits All" Replacement Tarp - 8' x 28' Mighty Mesh®	1801686	N/A
SWAT Wet Kit HDW	1809232	N/A
SWAT R/C HDW	1809398	N/A

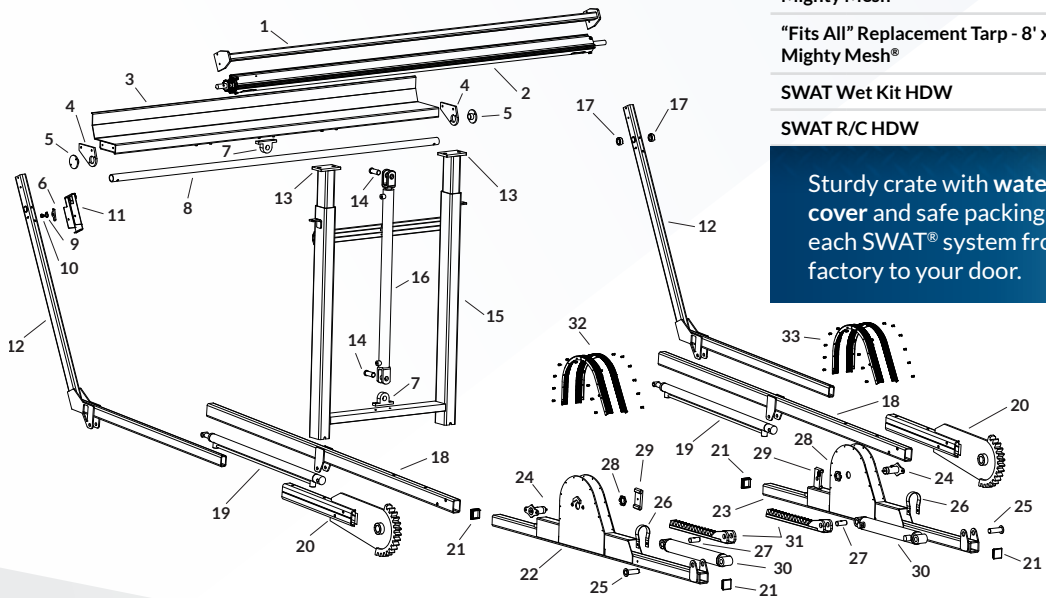

Sturdy crate with waterproof cover and safe packing protects each SWAT® system from our factory to your door.

Contact an Authorized Donovan Dealer Near You!

ROLL-OFF TARP SYSTEM



SWAT® is a fully adjustable automatic tarping system for 15 to 40 cubic yard containers. Designed with the end user in mind, the SWAT® was engineered to surpass all established technologies in the industry, thereby delivering maximum uptime and safety at a competitive price.



2309 Shur-Lok St.  
Yankton, SD 57078  
P: 800-327-8287  
www.donovan-tarps.com







# BUILT TO BE THE BEST



## Gear and Rack

Precision-cut/built gear and rack ensures smooth, synchronous arm movement as intended. Eliminates gear slippage and pivot arm twisting. Increased longevity/decreased downtime.

## Flanged & Bolted Gear Pin

A flanged gear pin is bolted to the pivot housing. This prevents pin loss and enhances pivot arm security and smooth rotation.

## Bolt-Less Tarp Attachment

A high-quality roller bar design allows for fast and secure tarp attachment. Durable bearings contribute to longer service life. Three attachment options include spline, square nut and threaded slot.

## ADDITIONAL FEATURES

### Hard-Pipe Cylinders

— The hard-pipe cylinders with nitride coated rods reduce chances of hose damage.

### Mighty Mesh®

— The strongest truck tarp material on the market today.

### LiteALL® (Option)

— Durable light with diecast aluminum housing.

### Floodlight Mounting Brackets

— Gantry light mounting brackets and wiring protection tube are pre-installed.

### Tower Mount Plates

— Wider tower mount plates fit more hoist configurations, cutting down on installation time.

## BENEFITS

- SWAT® replacement parts are completely compatible with competitor rack and pinion system parts.
- Powder-coated parts provide premium finish and protection.
- 3/16" A500B steel arms, gussets and brackets engineered with exceptional durability to withstand demands of the industry.

- Low-profile arms avoid damage from wide containers and compactors.
- Quick-release tarp tube and standard tarp spline make tarp replacement a quick and easy, 1-person job.



## SYSTEM WARRANTY

**3  
YEAR\***

STEEL  
COMPONENTS  
AND TARP  
ROLLER SPRING

**1  
YEAR\***

HYDRAULIC  
VALVES

**90  
DAYS\***

TARP

\*From original Shur-Co® invoice date. Warranty against defects in material and workmanship. Details included in SWAT® Owner's Manual.

## Self-Contained Remote

The SWAT® is now available with a new self-contained remote control, making it the only steel-arm pivot tarp system in the industry with a remote control option. The remote allows drivers to take safer positions with better visibility during tarp operation. Additionally, the self-contained design isolates the tarp's hydraulics, protecting the tarp system from debris or other possible contamination from the truck's hydraulics.



## 8' x 28' Mighty Mesh® Fits All Tarp (P/N 1801686)

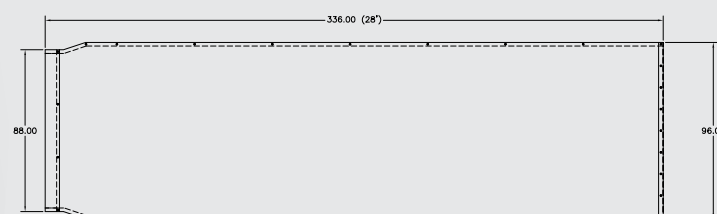

- Rectangular 8' x 28' construction
- Replacement tarp fits all brands of hydraulic roll off tarper
- Made of Mighty Mesh®...strongest tarp mesh available
- Tapered pocket end for ease of installation and enhanced appearance

## 9' 8" x 28' Mighty Mesh® Flap Tarp (P/N 1801640)

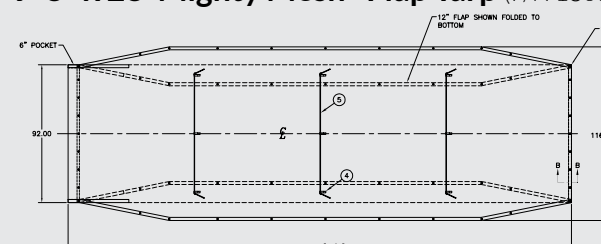

- Made of Mighty Mesh®...strongest tarp mesh available
- Side flaps on tarp extend lateral coverage
- Pre-installed bungee cord retracts flaps for smooth roll up

Tarp sold separately from SWAT® system. Most popular designs are shown. Other designs available.